

## Natura 92

## Thermal Performance Report

Date: 12/17/2019  
 Type: Tilt / Turn Window  
 Glass: 48mm Planitherm XN (#2, #5), 4/18/4/18/4

### North American Standard

Performance values modeled with LBNL THERM & Window7 per NFRC 100 & 200  
 47" x 59" Window size @ standard 0°F exterior temperature

Glass:	$U_g = .126$ Btu/hr-ft <sup>2</sup> F	SHGC = .51	VLT = .74	
Window:	$U_w = .153$ Btu/hr-ft <sup>2</sup> F	SHGC = .35	VLT = .50	CR = 79

### European Standard

Performance values modeled with LBNL THERM & Window7 per ISO 673 / EN 673  
 48" x 58" Window size @ standard 32°F exterior temperature

Frame:	$U_f = .174$ Btu/hr-ft <sup>2</sup> F	Frame (sill):	$U_f = .182$ Btu/hr-ft <sup>2</sup> F
Spacer:	$\Psi = .0150$ Btu/hr-ft-F	Spacer (sill):	$\Psi = .0158$ Btu/hr-ft-F
Glass:	$U_g = .097$ Btu/hr-ft <sup>2</sup> F		
Window:	$U_w = .135$ Btu/hr-ft <sup>2</sup> F		

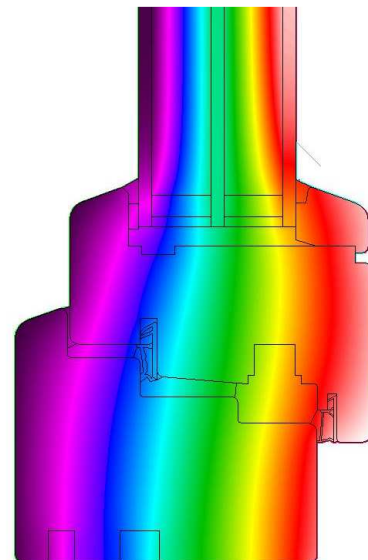
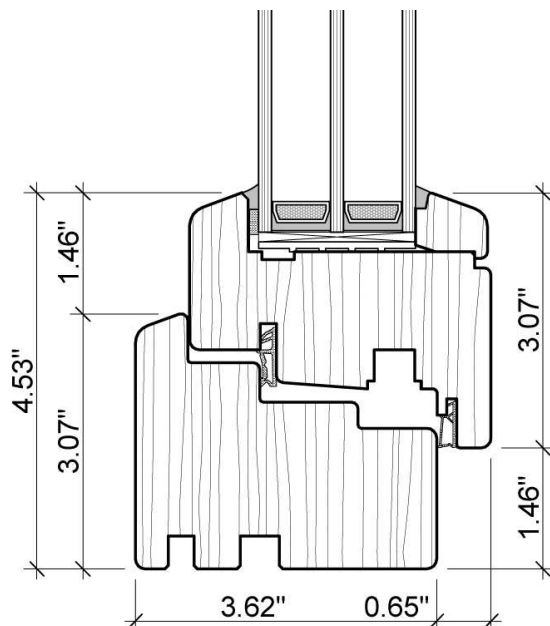

# Natura 92

# Thermal Performance Report

## Climate Specific Performance

Performance values modeled with LBNL THERM & Window7 per ISO 673 / EN 673  
48" x 58" Window size @ climate specific winter exterior temperatures

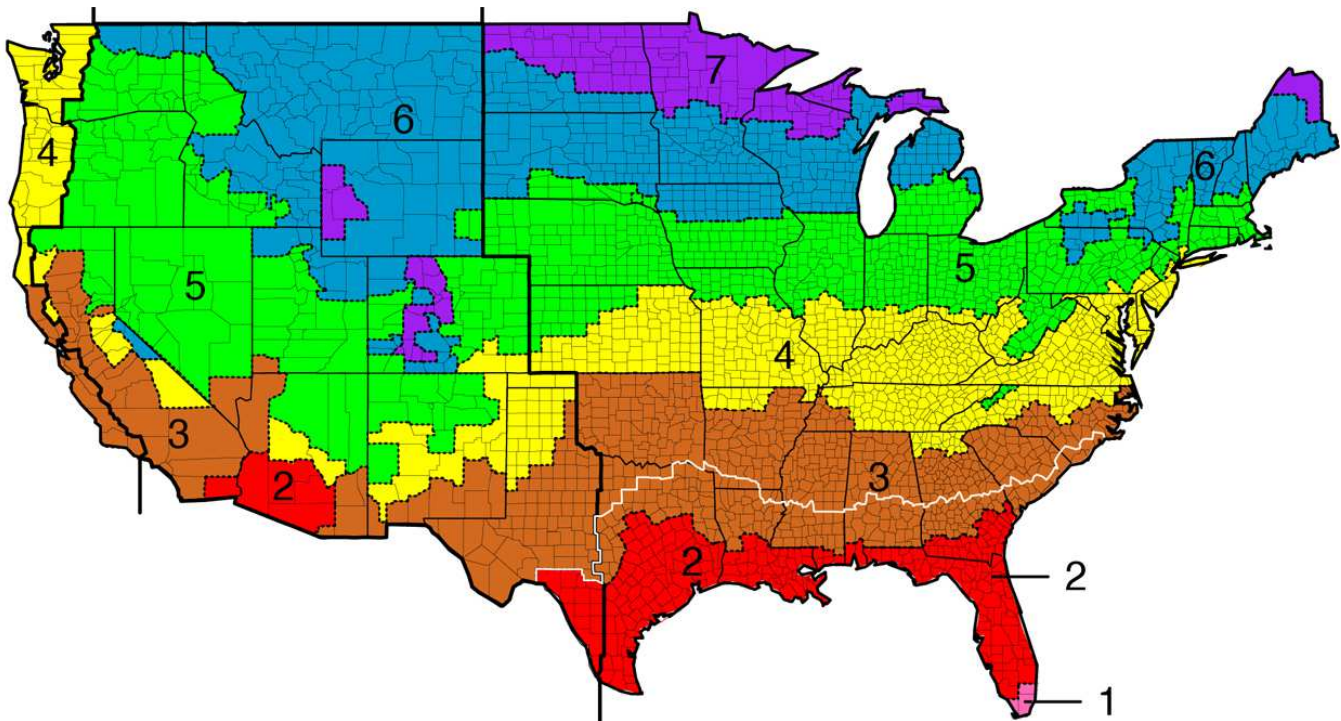

Frame:  $U_f = .174$  Btu/hr-ft<sup>2</sup>F      Frame (sill):  $U_f = .182$  Btu/hr-ft<sup>2</sup>F  
 Spacer:  $\Psi = .0147$  Btu/hr-ft-F      Spacer (sill):  $\Psi = .0156$  Btu/hr-ft-F  
 Glass: SHGC = .51

Climate Zone	Glass U-Value Btu/hr-ft <sup>2</sup> F	Window U-Value Btu/hr-ft <sup>2</sup> F
Zone 7 (10°F)	.112	.144
Zone 6 (25°F)	.103	.138
Zone 5 (28°F)	.100	.131
Zone 4 (36°F)	.096	.133